



CITYPLACE  
TOWER



## SUITE 1800

TOTAL AVAILABLE

**25,142**<sup>RSF</sup>

### Building Highlights

- LEED Silver Certified
- 100% Generator Backup System
- Ocean, Intracoastal Waterway & City Views
- Impact Resistant Windows
- State-of-the-Art Security System
- 4 Levels of Secure Parking

For Leasing Information  
[CityPlaceTower.com](http://CityPlaceTower.com)

**Andrew Gilpin**  
Director of Leasing

P 202.470.4867  
E [AGilpin@PGP.us.com](mailto:AGilpin@PGP.us.com)

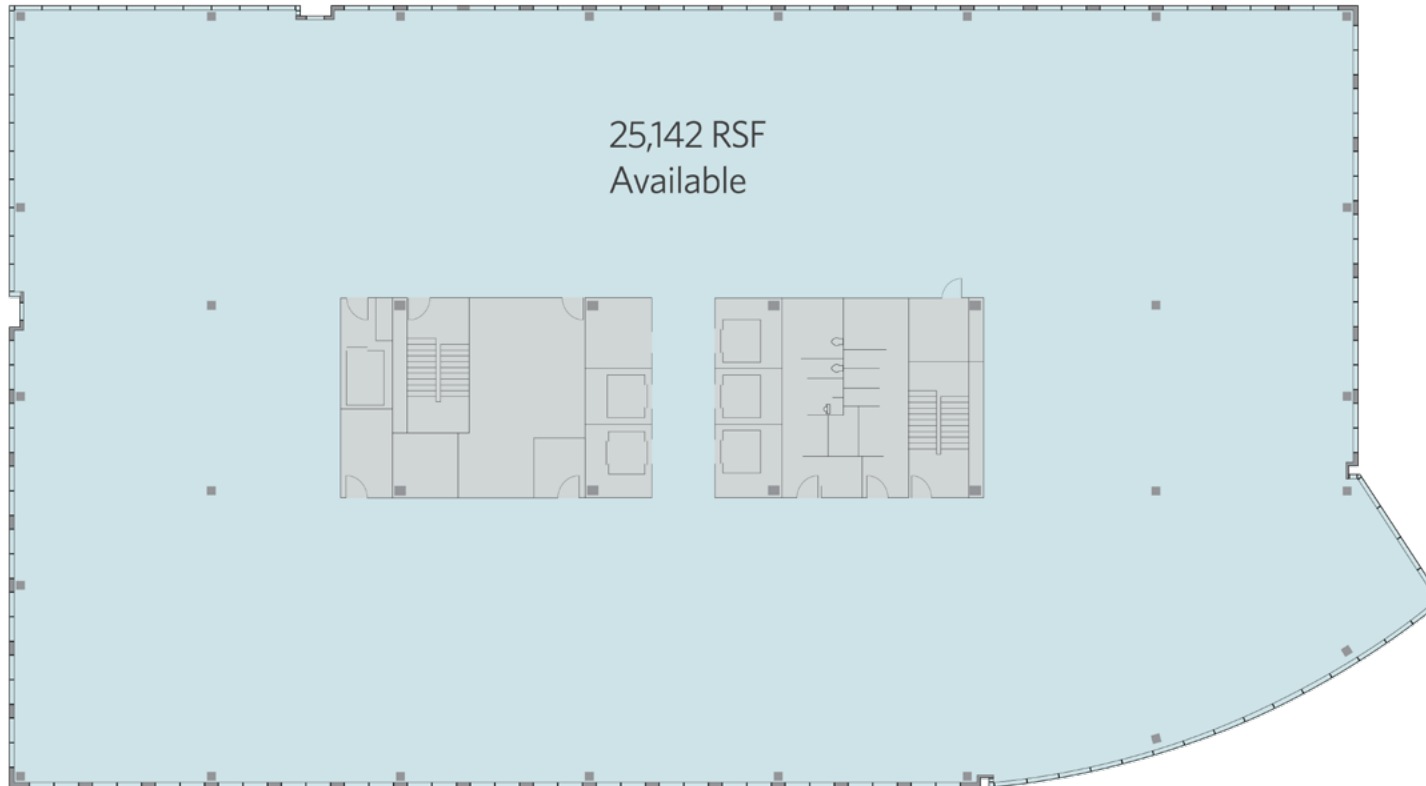

PROPERTY GROUP PARTNERS